



三片式法蘭端口球閥-PN16/PN40 | 3-PC Flanged End Ball Valve PN16/PN40 EA-305FE

產品特點 Feature

工作壓力：PN16/PN40
 規格：1/2"~4"(DN15~DN100)
 全流量
 法蘭端口：PN40/PN16(2-1/2"~4")
 防靜電裝置
 ISO 5211 驅動平台
 防爆閥桿
 防火設計符合API607第4版
 選擇性要求：帶鎖把手
 包球式球墊

Working Pressure: PN16/PN40
 Size: 1/2"~4" (DN15~DN100)
 Full Bore
 Flange End: PN40/PN16(2-1/2"~4")
 Anti-Static Device
 ISO 5211 Mounting Pad
 Blow-out-proof Stem
 Fire Safe Design to API607 4th Edition
 Optional: Locking Handle
 Cavity Filler

產品規格 Specification

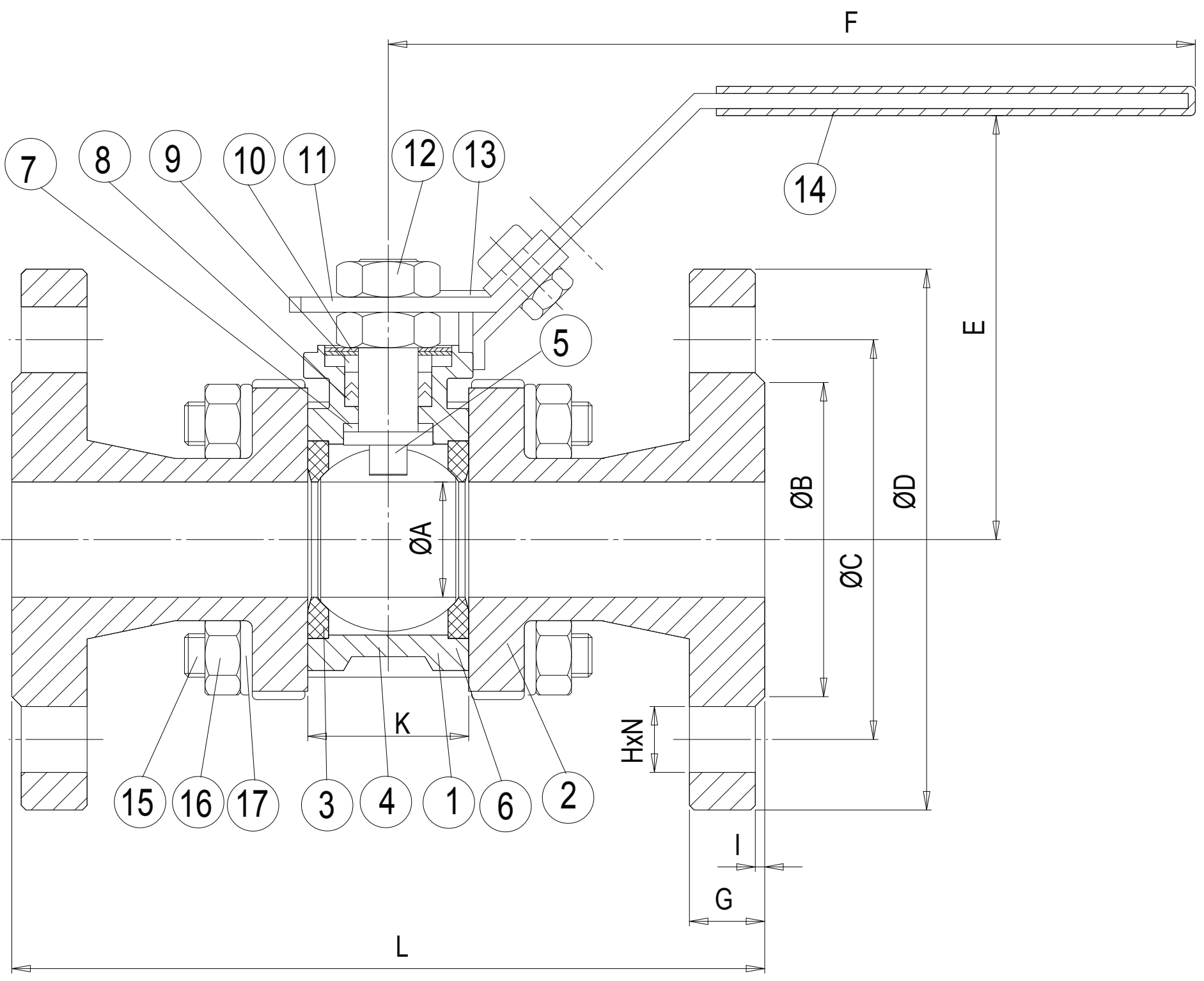

ITEM	PARTS NAME	MATERIAL		QTY
1	BODY	ASTK A351.GR.CFBM	ASTK A216. GR. WCB	1
2	END CAPS	ASTK A351.GR.CFBK	ASTK A216. GR. WCB	2
3	SEATS	PTFE + 15" G.F.	PTFE + 15% G.F.	2
4	BALL	ASTK A351.GR.CFBM	ASTII A351.GR.CF8M	1
5	STEM	SUS316	SUS304	1
6	BODY SEAL	PTFE	PTFE	2
7	GASKET	PTFE+15%G.F.	PTFE+15%G.F.	1
8	SEAL	PTFE	PTFE	1
9	GLAND RIN	SUS304	SUS304	1
10	SPRING WASHER	CARBON STEEL	CARBON STEEL	2
11	HANDLE	SUS304	CARBON STEEL	1
12	LEVER NUT	SUS304	SUS304	2
13	STOP SCREW	SUS304	SUS304	1
14	HANDLE COVER	VINYL	VINYL	1
15	BOLTS	SUS304	SUS304	4/6
16	SPRING WASHERS	SUS304	SUS304	8/12
17	BOLT NUTS	SUS304	SUS304	8/12
		EA-305A	EA-30 5C	

Dimension 尺寸

Unit: mm

Size	A	B			C			D			E	F	G			I		HXN			K	L		
		ANSI	PN16	PN40	ANSI	PN16	PN40	ANSI	PN16	PN40			ANSI	PN16	PN40	ANSI	DIN	ANSI	PN16	PN40		ANSI	DIN	
15	1/2	16	35	45	45	66.5	65	65	95	95	95	78.7	140	14.2	14	16	2	1.5	16x4	14x4	14x4	25.2	139.7	130
20	3/4	20	43	58	58	82.5	75	75	117	105	105	81.2	140	15.7	16	18	2	1.5	19x4	14x4	14x4	27.2	152.4	150
25	1	24.5	51	68	68	89	85	85	124	115	115	94.8	170	17.5	16	18	2	1.5	19x4	14x4	14x4	33	165.1	160
32	1 1/4	32	65	78	78	98.5	100	100	133	140	140	100	170	19	16	18	2	1.5	19x4	18x4	18x4	41.2	177.8	180
40	1 1/2	28	73	88	88	114.3	110	110	155	150	150	110	230	20.5	16	18	3	1.5	22x4	18x4	18x4	49.3	190.5	200
50	2	50	92	102	102	127	125	125	165	165	165	118.5	300	22.5	18	20	3	1.5	22x8	18x4	18x4	63.3	215.9	230
65	2 1/2	65	105	122	122	149.3	145	145	190	185	185	148.5	380	25.4	18	22	3	1.5	22x8	18x4	18x8	82.1	241.4	290
80	3	80	127	138	138	168	160	160	209	200	200	159.5	400	28.4	20	24	3	1.5	22x8	18x8	18x8	95.8	282.4	310
100	4	100	157	158	160	200	180	190	254	220	235	174.6	400	31.8	20	24	3	1.5	22x8	18x8	22x8	117.8	304.8	350

■ We reserve the right to modify the design / specifications without previous notice for better quality.

■ 我方有權隨時變更設計/規格，以便提供品質優良的產品。